

Showcase Chevrolet AUTO DEALERSHIP



5400 GARDEN GROVE BOULEVARD
WESTMINSTER, CALIFORNIA



405/22 FREEWAY FRONTAGE AT VALLEY VIEW

600,000 CARS PER DAY VISIBILITY

FOR LEASE ONLY

Showcase Chevrolet

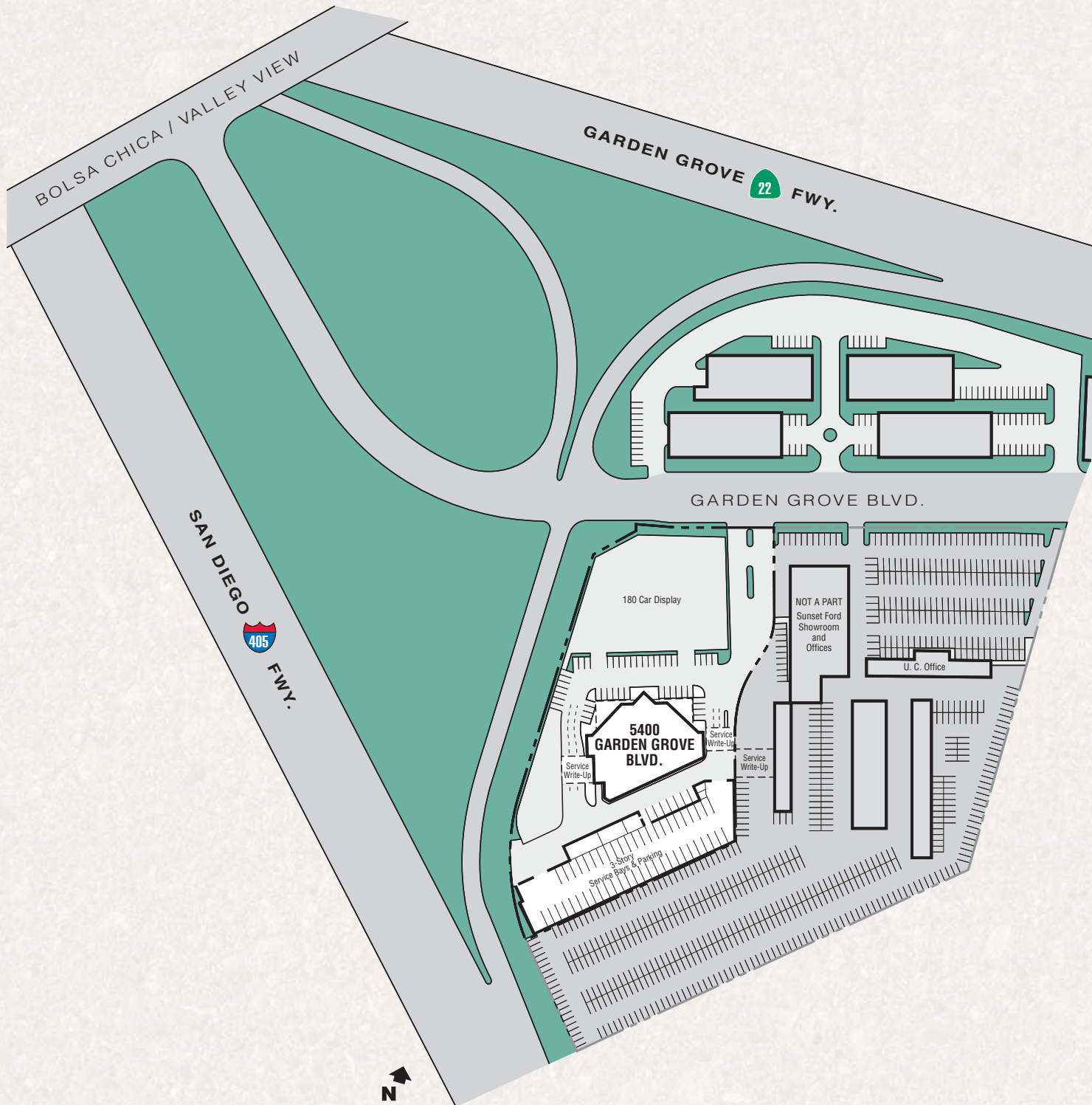

FEATURES

- Direct access via Valley View exit at the 405 Freeway
- 34,171 square foot showroom, office, parts store, customer lounge and warehouse
- Two-story, 64,528 square foot parking structure with 287 vehicle positions
- 34,371 square foot service garage with 58 service bays
- 265 surface positions
- Not for Sale - For Lease Only
- \$50,000 NNN Monthly

Westminster, California

Parking Structure

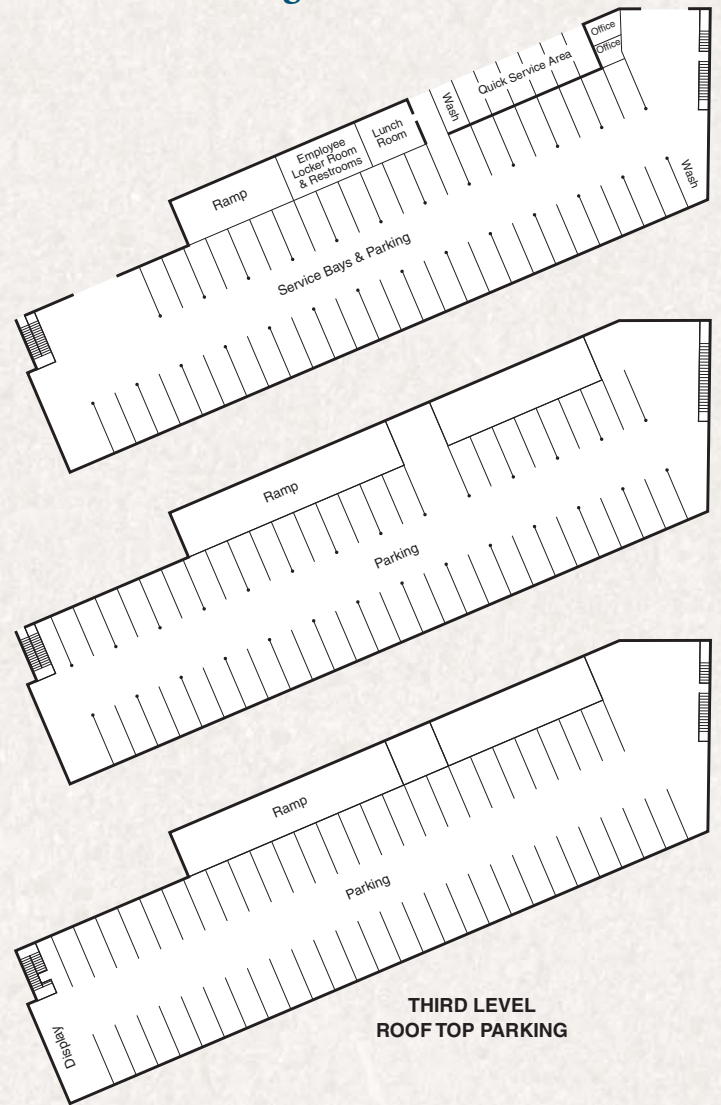
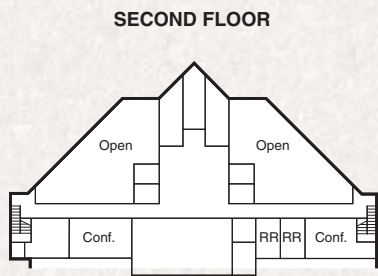
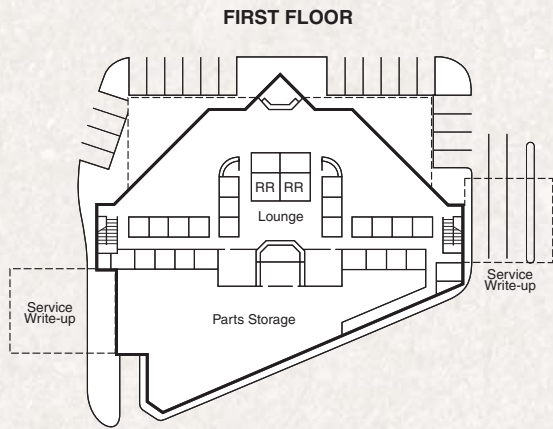

**THIRD LEVEL
ROOF TOP PARKING**

Showroom	Area (Sq. Ft.)
1st Floor Showrooms	4,780
1st Floor Offices	3,090
1st Floor Retail Parts	700
1st Floor Parts Storage	6,430
1st Floor Lounge	430
1st Floor Service Write-up	310
1st Floor Patio	2,300
2nd Floor Offices	5,230
Parking Structure	
Service Bays	32,390
2nd Floor Parking	30,120
3rd Floor Parking	28,450
3rd Floor Car Display	1,670





For further information, please contact:

Kevin Turner
 kturner@voitco.com

Michael Hartel
 mhartel@voitco.com

Joe Winkelmann
 jwinkelmann@voitco.com

Voit
 REAL ESTATE SERVICES

949-263-5395 / Fax 949-261-9092
 2020 Main Street, Suite 100, Irvine, CA 92614



The information contained herein has been obtained from sources we deem reliable. While we have no reason to doubt its accuracy, we do not guarantee it.